



WORLD CLASS WHOLESALE CABINETS

Trusted Supplier of Solid Wood Kitchen & Bathroom Cabinets

J&K Cabinetry is a leading wholesale supplier of high-quality and stylish kitchen and bathroom cabinets.

High Quality Solid Wood Cabinetry

All of our cabinets are made from 100% Birchwood. No MDF/Particle Boards or cheap material are used throughout the manufacturing process.

5-7 Day Average Lead Time On All Orders

We pride ourselves in having one of the most consistent and reliable lead times in the industry.

Premium Features Come Standard On All Cabinets

All cabinets come with soft close, full-extension drawers w/ concealed undermount, dovetail construction, etc.

15+ Colors & Finishes Available

One of the largest RTA cabinet wholesale collections in the nation with 498 total SKUs PER Color.

Semi-Customizable

Due to our large collection we are able to offer semi-customizable options to fit even the most unique types of projects.

Over 250,000+ sq ft of Combined Warehouse Space

Large supply of instock inventory at each of our 4 locations with the ability to supply a small kitchen to large apartment complex size jobs efficiently and effectively.

Explore our cabinetry collection

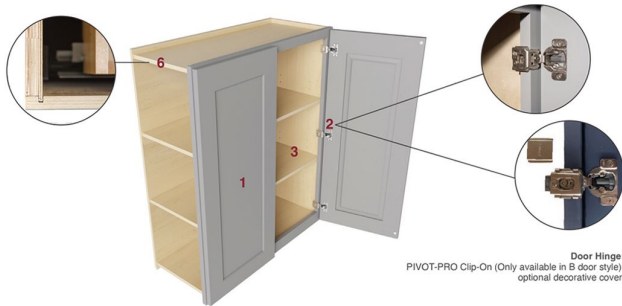
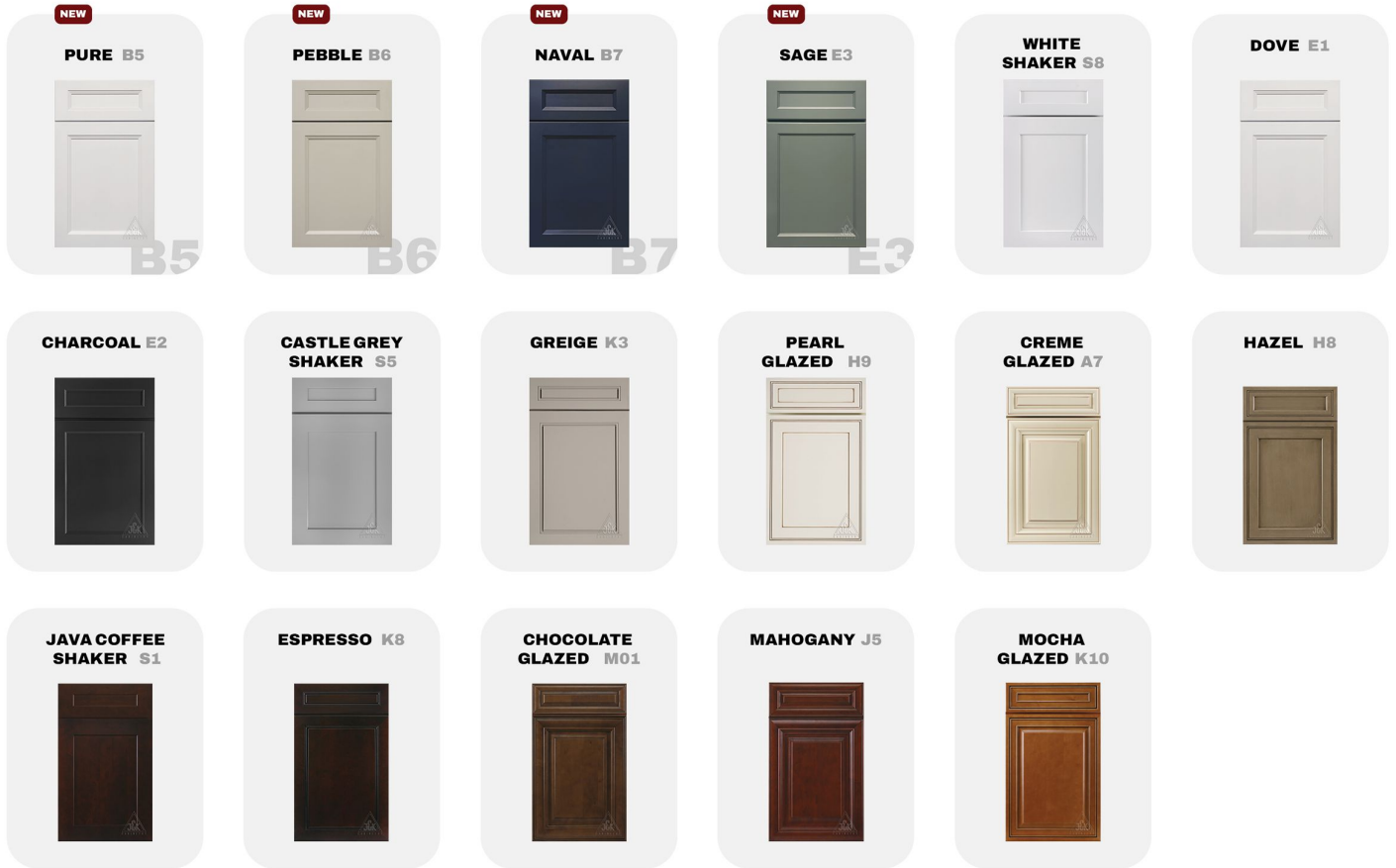

Wall Cabinet with two doors (Sample only).



Base Cabinet with one drawer and one door in Castle Grey (S5).

All J&K's cabinets and vanities are superiorly constructed with 100% solid wood and proudly come with the following STANDARD features:

DOOR PANEL

- 3/4" thick solid wood, full overlay door.

DOOR HINGE

- 6-way adjustable, soft-close metal and hidden Euro-style.
- PIVOT-PRO Clip-On (ONLY available in B door style): optional decorative cover.

ADJUSTABLE SHELF

- 3/4" thick cabinet-grade plywood, clear coat finish on all sides and edges; with metal shelf rests.

DRAWERS

- 5/8" thick solid wood on all sides, dovetail construction.

DRAWER GLIDE

- 3/4 to Full extension pull-out, soft-close metal and concealed under-mount.

PLYWOOD BOX

- 1/2" to 5/8" thick cabinet-grade plywood, clear coat finish on interior sides; matching color finish on exterior sides.

METAL BRACKET

- Corner bracket reinforcements in base cabinets for maximum stability.

DOOR BUMPER

- Promotes quiet-closing and reduces slamming for maximum durability